

OFFICE/RETAIL SPACE IN THE HEART OF ORLANDO'S TOURIST CORRIDOR



THE PROPERTY

- **FANTASY PLAZA**
- 2956-2960 VINELAND RD.,
KISSIMMEE, FL 34746



CONTACT

SERENITY LORENZ

VP of Sales & Leasing
Central Florida Office
(C) 904.887.3302
serenity@acrefl.com

SANDI BARGFREDE

Managing Partner
sandi@acrefl.com
(C) 407.419.8149

PROPERTY FEATURES

- **9,865 SF GROUND FLOOR RETAIL COMING AVAILABLE**
- Just off US 192 & CR 535
- Newly renovated property
- Located at signalized hard corner intersection
- High Traffic Counts- 64,000+ AADT
- Minutes from Walt Disney World & Sea World
- Surrounded by strong national retailers, restaurants, and hotels
- GLA: 14,398 SF



SITE PLAN | TRADE MAP | DEMOS

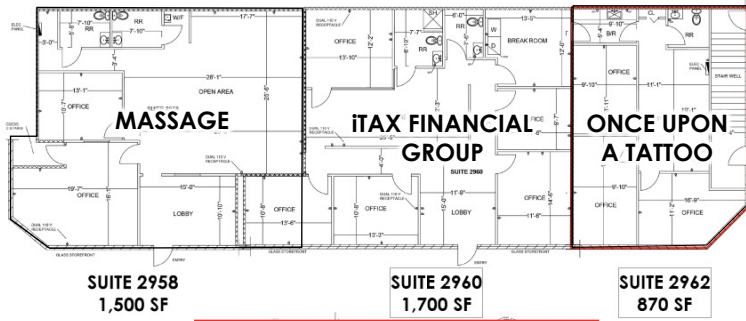

2023 DEMOGRAPHICS

POPULATION

1 MI- 9,289
3 MI- 48,983
5 MI- 141,040

AVG HH INCOME

1 MI- \$30,174
3 MI- \$58,999
5 MI- \$72,288

DAYTIME POPULATION

1 MI- 2,184
3 MI- 14,152
5 MI- 63,750

MEDIAN AGE

1 MI- 32.3
3 MI- 33.6
5 MI- 34.7



CENTRAL FLORIDA: 47 E. Robinson Street | Suite 230 | Orlando, FL 32801
 WEST COAST FLORIDA: 730 S. Sterling Avenue | Suite 212 | Tampa, FL 33609
Office: 407.392.2055 | Fax: 321.400.1183 | www.acrefl.com